

FOR SALE

RESIDENTIAL - CONDOMINIUM 528SQFT (49SQM) / CALL FOR PRICE!

+65 9745 9959



1 - Bedroom

TYPE A1

#02-18 to #05-18

TYPE A1P

#02-18 to #05-18

#01-18

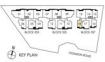

RESIDENTIAL - CONDOMINIUM

333 - 337 THOMSON ROAD, NEWTON, NOVENA,
SINGAPORE 307675

- LISTING ID: SGLD03049635
- TENURE: FREEHOLD
- TITLE: N/A
- SIZE BUILT-UP: 528SQFT (49SQM)
- SIZE LAND: 1.317AC (0.533HA)
- NO. OF FLOORS: 5
- FLOOR/LEVEL: N/A - N/A
- BED ROOMS: 1
- BATH ROOMS: 1
- MAIDS ROOMS: N/A
- PARKING SPACES: N/A
- LAYOUT TYPE: OTHER
- FACING: N/A
- VIEWING: OTHER
- SELLING PRICE: **CALL FOR PRICE!**
- COMPLETION YEAR: 2025
- CONDITION: ORIGINAL CONDITION
- FURNISHING: PARTIALLY FURNISHED
- LISTING DATE: MAY 06, 2021

PEAK RESIDENCE

Condominium for Sale: Partially furnished, 1 bedroom, 1 bathroom. Completed in 2025, this unit is in original condition. Tenure: Freehold Located in Singapore's district D11 near Newton, Novena in the area Newton (Central region).

INTERIOR FACILITIES

- Air-Conditioning
- Balcony

OTHER INTERIOR FEATURES

- Cooker Hob/Hood
- Dryer
- Fridge
- Intercom

EXTERIOR FACILITIES

- 24 Hours Security
- Clubhouse
- Covered Car Park
- Jacuzzi

VISIT THIS PROPERTY AT: <https://agents.huttonsgroup.com/R004269F/property/SGLD03049635>

VINCENT ONG - HUTTONS ASIA PTE LTD

3 Bishan Place #05-01 CPF Bishan Building
D20, 579838, Singapore

+65 9745 9959
WhatsApp Me

vo.huttons@gmail.com

<https://agents.huttonsgroup.com/R004269F>



Scan QR Code