

FOR SALE

RESIDENTIAL - CONDOMINIUM 1,109SQFT (103SQM) / CALL FOR PRICE!

+65 9380 0798

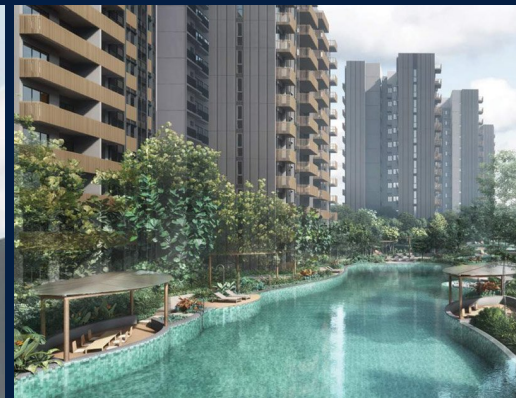

3 - Bedroom Premium

TYPE C4-G

103 sqm | 1,109 sqft
(Inclusive of 10 sqm PES
& 0 sqm AC, Ledger)

TYPE C4

103 sqm | 1,109 sqft
(Inclusive of 10 sqm PES
& 0 sqm AC, Ledger)

TYPE C4-P

122 sqm | 1,313 sqft
(Inclusive of 10 sqm PES
& 0 sqm AC, Ledger)



KIP HUN

RESIDENTIAL - CONDOMINIUM

BROOKVALE DRIVE, CLEMENTI PARK, UPPER BUKIT
TIMAH, SINGAPORE 599973

- LISTING ID: SGLD21639553
- TENURE: LEASEHOLD 999
- TITLE: N/A
- SIZE BUILT-UP: 1,109SQFT (103SQM)
- SIZE LAND: 7.808AC (3.160HA)
- NO. OF FLOORS: 12
- FLOOR/LEVEL: N/A - N/A
- BED ROOMS: 3+1
- BATH ROOMS: 2
- MAIDS ROOMS: N/A
- PARKING SPACES: N/A
- LAYOUT TYPE: OTHER
- FACING: N/A
- VIEWING: OTHER
- SELLING PRICE: **CALL FOR PRICE!**
- COMPLETION YEAR: 2024
- CONDITION: ORIGINAL CONDITION
- FURNISHING: PARTIALLY FURNISHED
- LISTING DATE: MAR 02, 2021

KI RESIDENCES

Condominium for Sale: Partially furnished, 3 bedroom, 2 bathroom + utility. Completed in 2024, this unit is in original condition. Tenure: Leasehold 999 Located in Singapore's district D21 near Clementi Park, Upper Bukit Timah in the area Central West (Central region).

INTERIOR FACILITIES

- Air-Conditioning
- Balcony

OTHER INTERIOR FEATURES

- Cooker Hob/Hood
- Dishwasher
- Dryer
- Fridge

EXTERIOR FACILITIES

- 24 Hours Security
- Clubhouse
- Covered Car Park
- Function Room

VISIT THIS PROPERTY AT: <https://agents.huttonsgroup.com/R007521G/property/SGLD21639553>



BERNARD ONG - HUTTONS ASIA PTE LTD

3 Bishan Place #05-01 CPF Bishan Building
D20, 579838, Singapore

+65 9380 0798
WhatsApp Me

bernard.ongte@gmail.com

L3008899K
R007521G

<https://agents.huttonsgroup.com/R007521G>



Scan QR Code