

FOR SALE

RESIDENTIAL - CONDOMINIUM 3,348SQFT (311SQM) / CALL FOR PRICE!

+65 9296 8795



4 - Bedroom

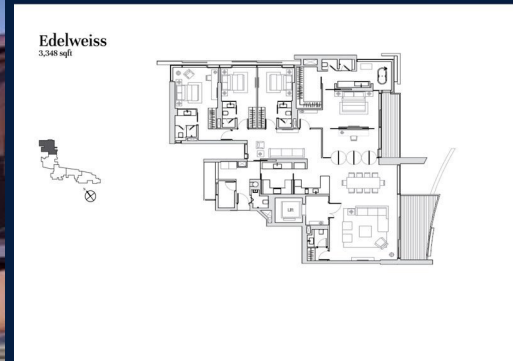

Edelweiss
3,348 sqft

RESIDENTIAL - CONDOMINIUM

11, STAMFORD ROAD, CITY HALL, CLARKE QUAY,
SINGAPORE 178884

- LISTING ID: SGLD00262327
- TENURE: LEASEHOLD 99
- TITLE: N/A
- SIZE BUILT-UP: 3,348SQFT (311SQM)
- SIZE LAND: 4.081AC (1.651HA)
- NO. OF FLOORS: 9
- FLOOR/LEVEL: N/A - N/A
- BED ROOMS: 4
- BATH ROOMS: 4
- MAIDS ROOMS: N/A
- PARKING SPACES: N/A
- LAYOUT TYPE: REGULAR
- FACING: N/A
- VIEWING: OTHER
- SELLING PRICE: **CALL FOR PRICE!**
- COMPLETION YEAR: 2015
- CONDITION: ORIGINAL CONDITION
- FURNISHING: PARTIALLY FURNISHED
- LISTING DATE: NOV 29, 2019

EDEN RESIDENCES CAPITOL

Spacious 3,348sqft (311sqm), partially furnished, 4 bedroom, 4 bathroom Condominium for Sale. Completed in 2015, this unit is in original condition. Others: Leasehold 99 This property is currently vacant and ready to move in. Located in Singapore's district D06 near City Hall, Clarke Quay in the area City Hall (Central region).

INTERIOR FACILITIES

- Air-Conditioning
- Cable TV
- Balcony

OTHER INTERIOR FEATURES

- Cooker Hob/Hood
- Dryer
- Dishwasher
- Fridge

EXTERIOR FACILITIES

- 24 Hours Security
- Landscaped Garden
- Covered Car Park
- Swimming Pool

VISIT THIS PROPERTY AT: <https://agents.huttonsgroup.com/R042661C/property/SGLD00262327>



SABRINA RUSKIN - HUTTONS ASIA PTE LTD

3 Bishan Place #05-01 CPF Bishan Building
D20, 579838, Singapore

+65 9296 8795
WhatsApp Me

rinar7201@gmail.com

L3008899K
R042661C

<https://agents.huttonsgroup.com/R042661C>



Scan QR Code